

# Toggle Switch

*Pre-packaged  
25 switches per box  
20 boxes per case*



**C** **UL** **US**  
E469421 / E209062

- ◆ 20 Amp, 125 VAC, 2 HP
- ◆ 15 Amp, 277 VAC, 2 HP
- ◆ 12" lead wires
- ◆ Internal Toggle Seal
- ◆ Silicone Boot
- ◆ On-Off Faceplate
- ◆ For 1/2" panel opening
- ◆ Recognized to U.S. and Canadian standards
- ◆ Per UL48, 20 Amp VAC rated switches are limited to a total transformer load of 10 Amps.

Description	Part Number	Catalog Number	Packaging	Weight
Toggle Switch, 20 Amp	39139	SW20-2HP	25 per box	3lbs./box

[www.westrimproducts.com](http://www.westrimproducts.com)

# Toggle Switch

## Installation Instructions

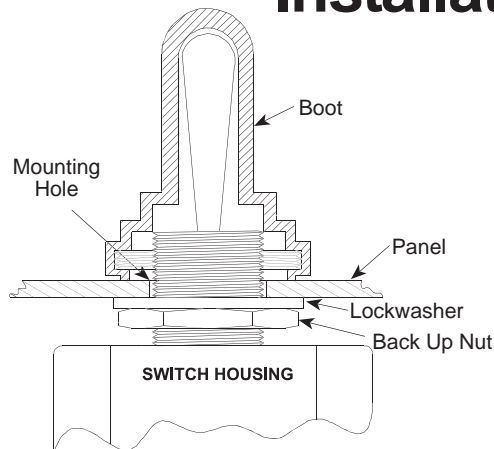

1. Drill or punch 1/2" hole through mounting surface. De-burr.
2. Remove one nut and "on/off" plate, leaving one nut and lockwasher on switch.
3. With switch in mounting hole, check that barrel extends 3 to 4 threads beyond face mounting surface.
4. Adjust nut still on switch to obtain this distance.
5. Place switch in mounting hole.
6. For dry locations, slide "on/off" plate over barrel, followed by nut, and tighten.

### NOTE:

7. For wet/damp locations, slip water protection boot/nut over toggle and tighten against mounting surface to create water seal. **DO NOT USE THE 1 INCH "ON/OFF" PLATE OR 2ND NUT SUPPLIED WITH THE SWITCH AS THIS COULD ALLOW WATER TO ENTER BETWEEN MOUNTING SURFACE AND BOOT.** The mounting surface may be the sign enclosure or can be a Switch Safety Locking Plate that has been sealed to the sign enclosure and can pass the enclosure water exclusion test of UL 48.
8. For "on/off" indication when using boot, use the decals provided.

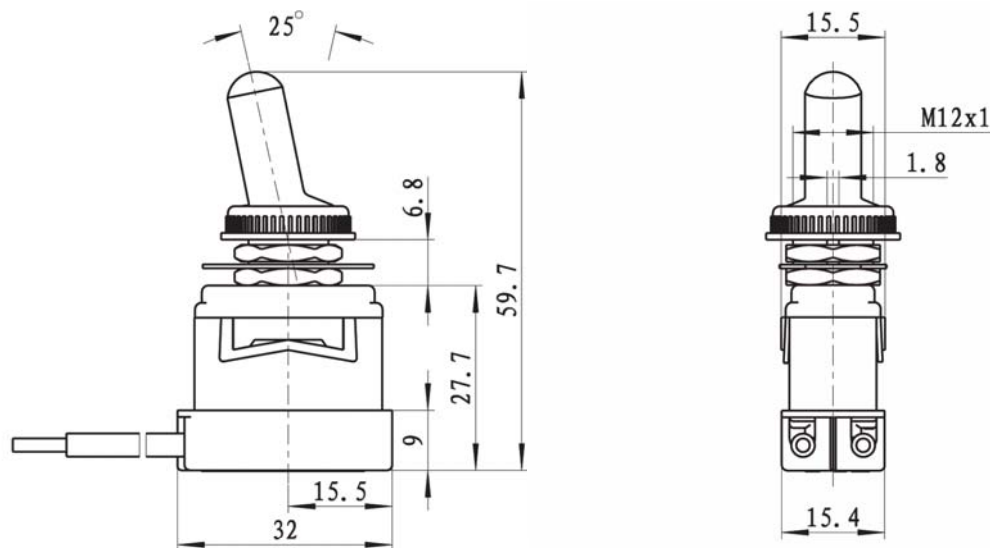

Dimensions in mm

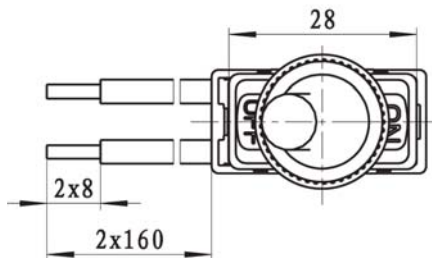

xs09055 02/13/15